

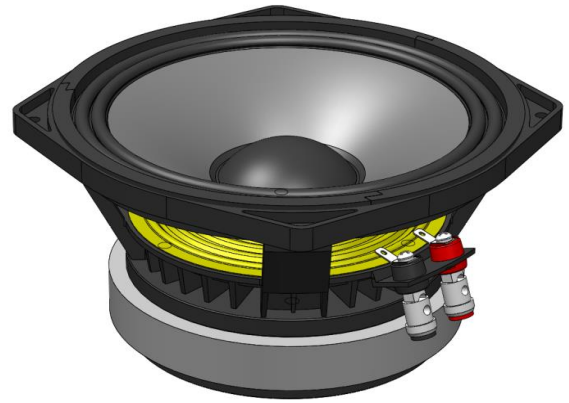

# 2440

Nominal Diameter	8 " / 20 cm
Rated Impedance	8
Sensitivity	94.5 dB SPL
Power Handling Capacity	200 W AES
SPL max (continuous)	114 dB SPL
Usable frequency range	80 - 4000 Hz
Speaker net mass	4.5 kg

# 8 inches low-mid driver



### Architecture highlights :

- Forced-air Intercooling System for low thermal compression
- High compliance double half-roll Fabric Surround
- One side coated diaphragm (Humidity proof withstanding)

### Motor architecture

Magnet material	-	Fe
Voice coil diameter	mm	51
Voice coil length	mm	14
Air gap height	mm	8

### Typical characteristics

Rated impedance	Z	Ω	8
Half space sensitivity (1W@1m)	-	dB SPL	94.5
Usable freq. range	-	Hz	80 - 4000
Power handling capacity (AES)	-	W	200
Max Sound Pressure Level	SPL <sub>max</sub>	dB SPL	114
Min. impedance modulus	Z <sub>min</sub>	Ω@Hz	5.4@410
Voice-coil inductance @ 1kHz	Le <sub>1k</sub>	mH	0.746
Voice-coil inductance @ 10kHz	Le <sub>10k</sub>	mH	0.423
BL product	BL	N/A	12.8
Moving mass	Mms	kg	0.0220

### Thiele-Small parameters

Resonance frequency	Fs	Hz	77 (±12)
DC Resistance	Re	Ω	5.2 (±0.5)
Mechanical quality factor	Qms	1	4.27
Electrical quality factor	Qes	1	0.34
Total quality factor	Qts	1	0.31
Suspension compliance	Cms	10 <sup>-6</sup> .m/N	190
Effective piston area	Sd	m <sup>2</sup>	0.0219
Equivalent Cas air load	Vas	m <sup>3</sup>	0.0131
Max linear excursion	Xmax	mm	± 5.0
Linear displacement volume	Vd	10 <sup>-3</sup> .m <sup>3</sup>	0.1095
Reference efficiency	η <sub>0</sub>	%	1.7
Unity load volume	Vas.Qts <sup>2</sup>	10 <sup>-3</sup> .m <sup>3</sup>	1.3

### Absolute maximum ratings

Short term max. input voltage	Vmax	V	80
Max.excursion before damage	Xdam	mm	± 10.0
Ambient operating temperature	Ta	°C	-10 to +50
Storage temperature		°C	-20 to +70
Environmental withstanding			Humidity proof

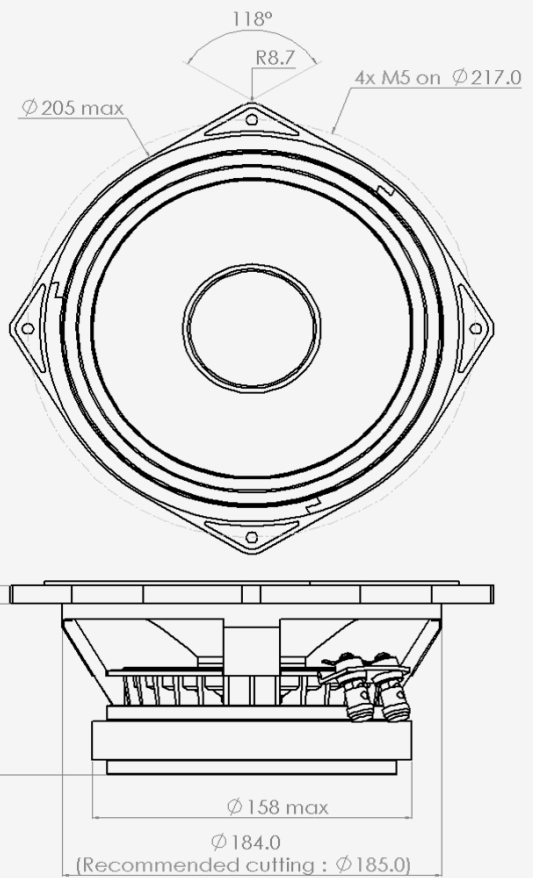

### Mounting information

Air volume occupied by the driver	10 <sup>-3</sup> .m <sup>3</sup>	1.00
Speaker net mass	kg	4.50
Baffle cut-out diameter (front mounting)	mm	185.0
Bolt number & Metric diameter	-	4x M5
Bolt circle diameter	mm	217.0
Max overall dimension (on ears)	mm	234.0
Max overall dimension (out of ears)	mm	205.0
Flange height	mm	9.5
Max magnet diameter	mm	158.0
Max depth (front mounting)	mm	90.0
Recommended reflex box	Lts / Hz	-
Electrical connection		Ø4 mm Push buttons



2440

8 inches low-mid driver

SPL curves measured on CEI standard baffle :

- . at 25 cm, normalised 1 m
- . at 1 m for reference
- . Graph amplitude = 60 dB (PHL Audio standard)

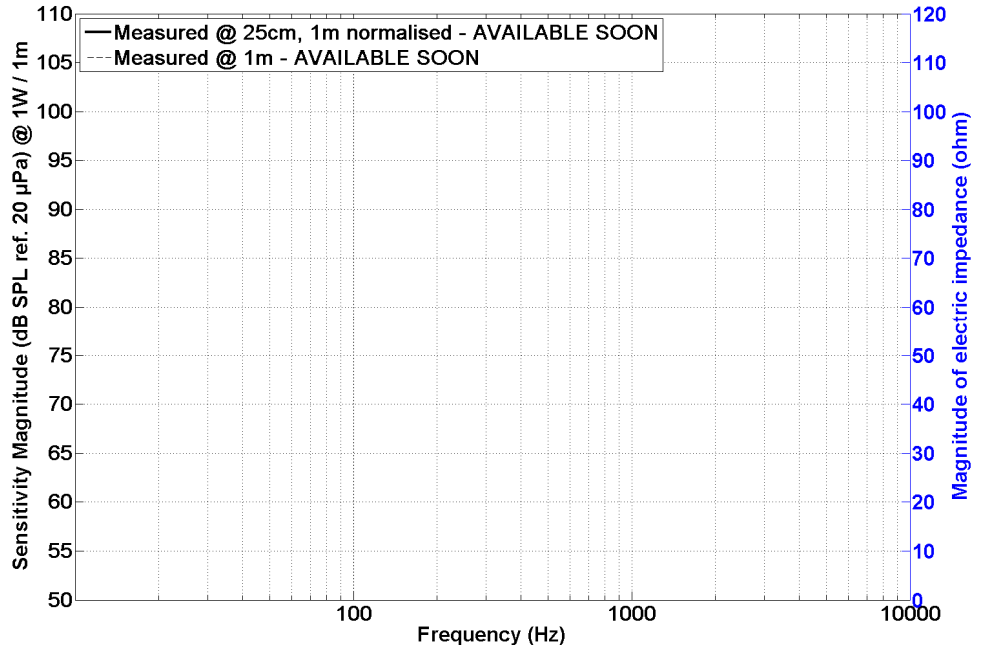

HD curve measured on CEI standard baffle :

- . at 1 meter
- . at power =  $P_{AES} / 4$
- . Graph amplitude 0.01 % to 100 % (PHL Audio standard for  $P_{AES}/4$ )

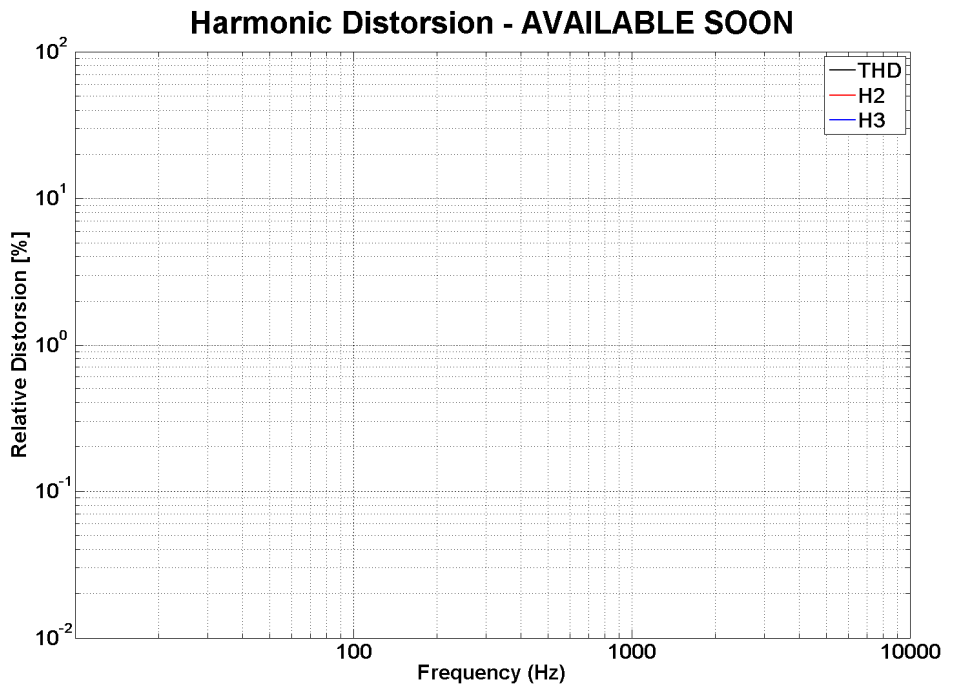

Non linear curves measured thanks to Klippel software and hardware, in free air

